

# SPLIT-LEVEL HOMES

## Plot 3.12

3 Bedroom, Type M-3B

### Total Area

105.3m<sup>2</sup>

1,133ft<sup>2</sup>

### Kitchen / Living / Dining

7,926 x 4,070mm

26' 0" x 13' 4"

### Master Bedroom

4,001 x 2,920mm

13' 2" x 9' 7"

### Bedroom 2

3,726 x 3,160mm

12' 3" x 10' 4"

### Bedroom 3

3,250 x 2,188mm

10' 8" x 7' 2"

C = Cupboard

WD = Washer Dryer

W = Wardrobe

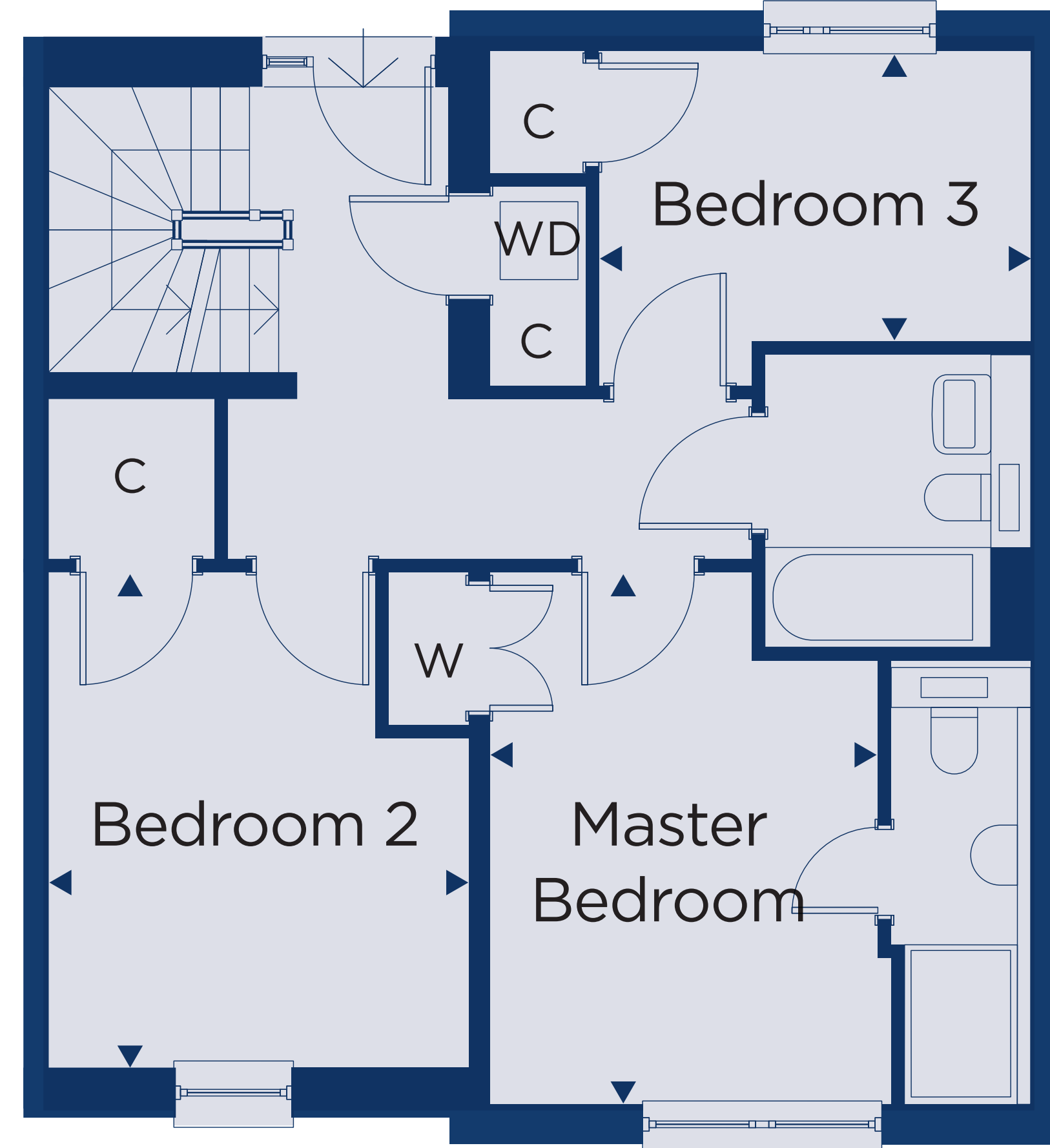

SECOND FLOOR



THIRD FLOOR

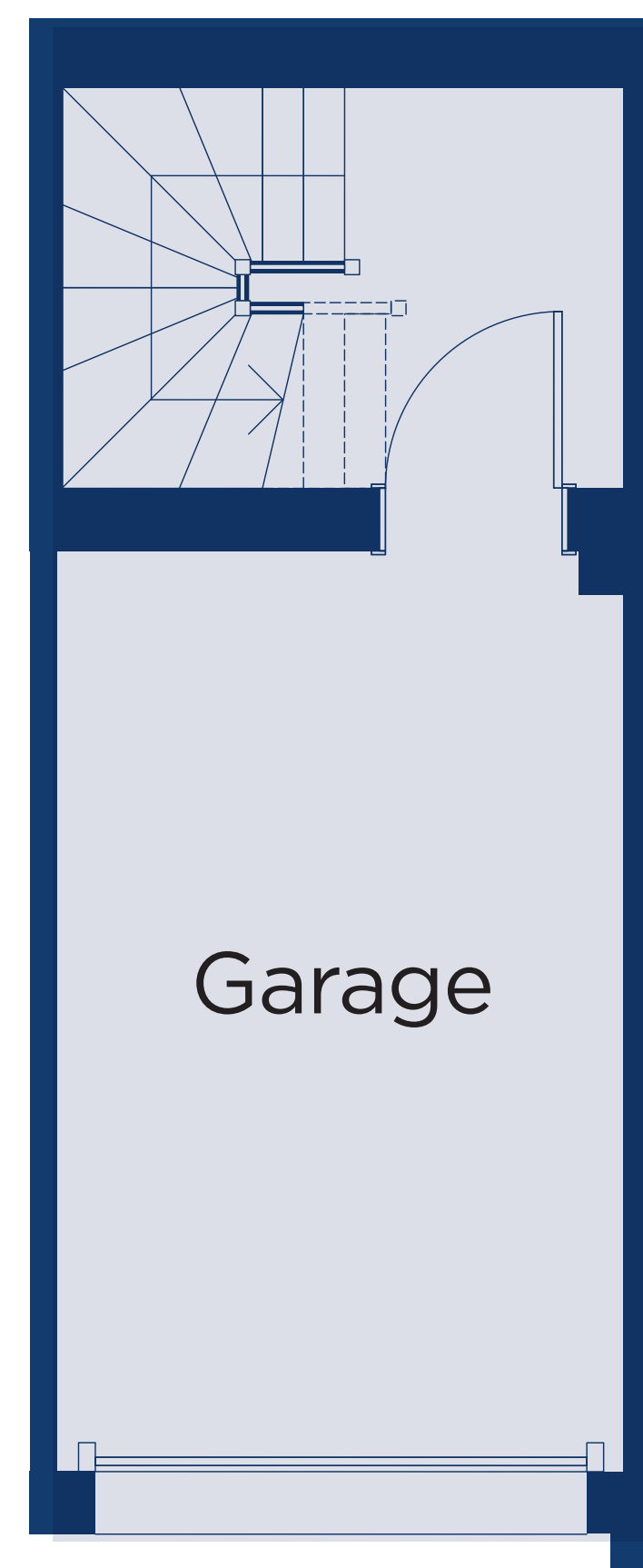

GROUND FLOOR

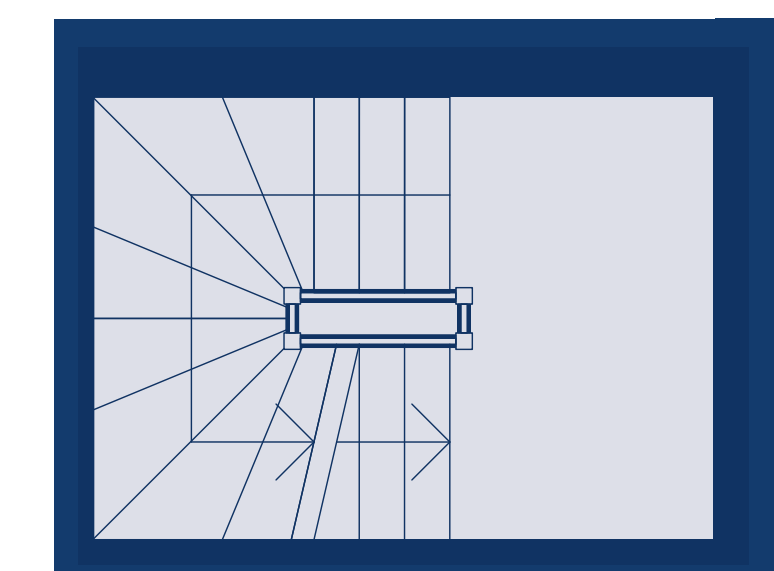

FIRST FLOOR